

MPP (MP)

Standard: CONNESSIONI LATERALI - SIDE PORTS - ANSCHLÜSSE SEITLICH

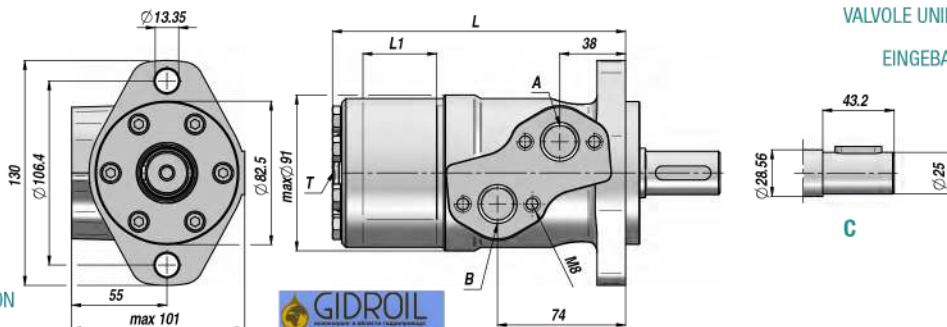

VALVOLE UNIDIREZIONALI INCORPORATE
BUILT-IN CHECK VALVES
EINGebaUTE RÜCKSCHLAGVENTILE

PREDISPOSTO PER IL DRENAGGIO
MACHINED FOR DRAIN CONNECTION
FÜR DRÄNLEITUNG GEEIGNET

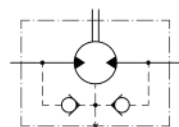

Codice Code Bestell-Nr.	Tipo Type Typ	cm ³ /giro cm ³ /rev cm ³ /U	n. Max giri/min rpm - U/Min.	M Max daNm	Q MAX l/min	P MAX bar			A - B	T	L	L1	kg
						Caduta Drop Gefälle Δp	Ingresso Inlet Eingang	Ritorno Return Rücklauf					
LAVORO CONTINUO - CONTINUOUS WORK - DAUERARBEIT													
MSP025NC25**	MPP 25 CD	25,0	1600	3,3	40	100	175	175 *			134	5,20	5,60
MSP032NC25**	MPP 32 CD	32,0	1560	4,3	50	100	175	175 *			135	6,30	5,60
MSP040NC25**	MPP 40 CD	40,0	1500	6,2	60	120	175	175 *			136,5	7,40	5,70
MSP050NC25	MPP 50 C	49,5	1210	9,4	60	140	175	175 *			135,5	6,67	5,80
MSP080NC25	MPP 80 C	79,2	755	15,1	60	140	175	175 *			139,5	10,67	5,90
MSP100NC25	MPP 100 C	99,0	605	19,3	60	140	175	175 *			142	13,33	6,10
MSP125NC25	MPP 125 C	123,8	486	23,7	60	140	175	175 *	1/2"	1/4"	145,5	16,67	6,20
MSP160NC25	MPP 160 C	158,4	378	31,3	60	140	175	175 *			150	21,33	6,40
MSP200NC25	MPP 200 C	198,0	303	36,6	60	140	175	175 *			155,5	26,67	6,60
MSP250NC25	MPP 250 C	247,5	242	38,0	60	110	175	175 *			162	33,33	6,80
MSP315NC25	MPP 315 C	316,8	190	38,0	60	90	175	175 *			171,5	42,67	7,10
MSP400NC25	MPP 400 C	396,0	150	36,0	60	70	175	175 *			182	53,33	7,60
MSP500NC25	MPP 500 C	495,0	120	39,0	60	60	140	140 *			195,5	66,63	8,90
MSP630NC25	MPP 630 C	623,6	95	44,0	60	55	140	140 *			213	84,00	9,50

* = CON DRENAGGIO - WITH DRAIN - MIT DRÄNLEITUNG

** Solo Versione "D" - "D" Version only - Nur Version "D" (vedi grafico - see diagram - siehe Diagramm)

OPTION

OPTION

OPTION

**PRESSIONE MAX. AL RITORNO SENZA DRENAGGIO
MAX. RETURN PRESSURE WITHOUT DRAIN
MAX GEGENDRUCK OHNE DRÄNLEITUNG**

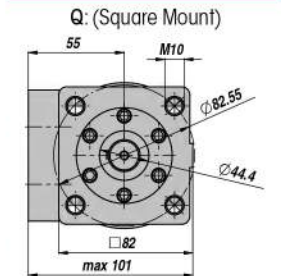
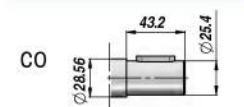

E: CONNESSIONI POSTERIORI
REAR PORTS
ANSCHLÜSSE HINTEN

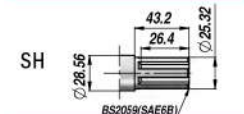
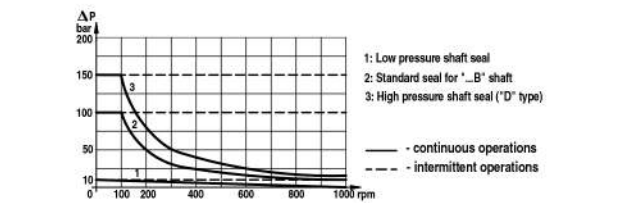
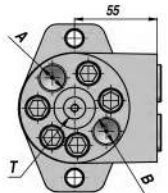

F: SAE A/4 (Oval Mount)

**CARICHI AMMESSI SULL'ALBERO
PERMISSIBLE SHAFT LOADS
ZULÄSSIGE WELLENBELASTUNGEN**

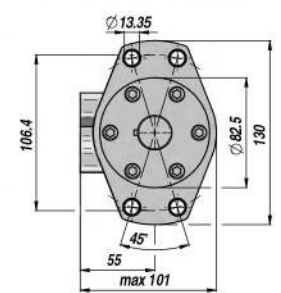
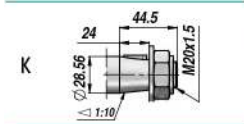

Albero - Shaft - Welle : "C-CO"

Con cuscinetti a rulli - With Needle bearings - Mit Rollenlagern : "N"

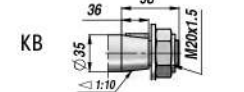
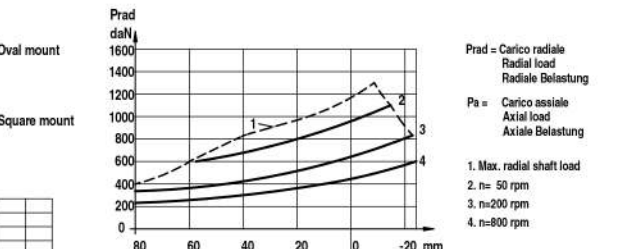
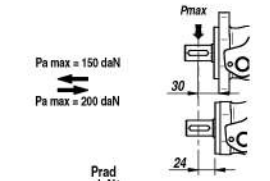
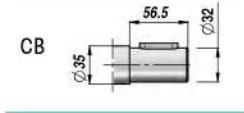

VERSIONI SPECIALI - SPECIAL VERSIONS - SPEZIELLE VERSIONEN

D: guarnizione albero - shaft seal - Wellendichtung; max 150 bar
N/D: con cuscinetti a rulli - with needle bearings - mit Rollenlagern
W: versione ruota - wheel mount - Radversion

